

Carolina Mountain Vacation Rentals, Inc.

8 N Jefferson Ave

PO Box 1518

West Jefferson, NC 28694

13366201050

Carolina Mountain Vacation Rentals, Inc.



Grapevine Retreat

The Grapevine Retreat Ground Floor

- A. The Playroom
 - 1. Large Screen TV
 - 2. Gas Logs
 - 3. Kitchenette
 - 4. Dining Table
 - 5. Ping-Pong Table
 - 6. Books
- B. Mechanical/Electrical Closet
- C. Powder Room
- D. Sports Equipment Storage
- E. The ELM Room
 - 1. King Bed
 - 2. TV
 - 3. Ensuite Bathroom
- F. The FIR Room
 - 1. King Bed
 - 2. TV
 - 3. Ensuite Bathroom
- G. The GUM TREE Room
 - 1. King Bed
- H. The HICKORY Room
 - 1. Two Twin XL Beds
- I. Hallway Bathroom
- J. Laundry Room
- K. Main Entrance from Carport

Outdoor Amenities Include Basketball Goal, Pop-up Soccer Nets, Bocce Balls, Corn Hole, Large Field for Soccer and/or Football, Park-Style Charcoal Grill, Plenty of Parking

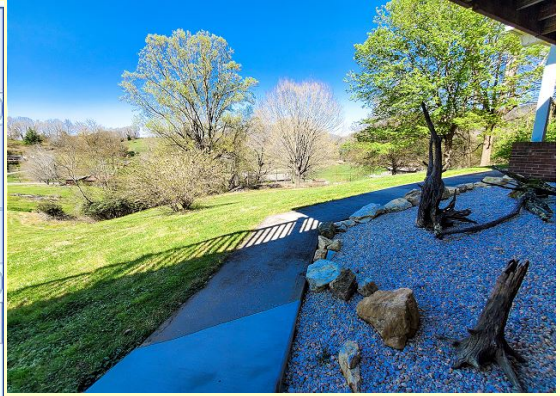

The Grapevine Retreat Top Floor

- A. The APPLE Room
 - 1. King Bed
 - 2. TV
- B. The BIRCH Room
 - 1. King Bed
 - 2. TV
- C. The CEDAR Room
 - 1. King Bed
 - 2. TV
 - 3. Ensuite Bathroom
- D. The DOGWOOD Room
 - 1. Two Twin XL Beds
- E. Laundry Room
- F. Breakfast Nook
- G. Kitchen
 - 1. Gas Stove
 - 2. Double Ovens
 - 3. Dishwasher
- H. Hallway Bathroom
- I. Dining Room
- J. Living Area
 - 1. Large Screen TV
 - 2. Gas Logs
- K. Front Door
- L. Back Door
- M. Entrance to Large Deck
 - 1. Rocking Chairs
 - 2. Bistro Tables

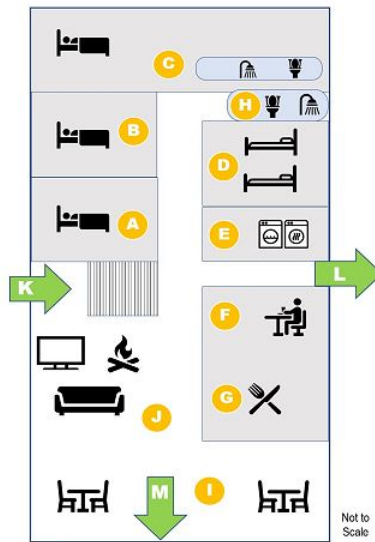

Not to Scale

Experience the beauty and breathtaking views of the Carolina Mountains in this family sized vacation rental that screams comfort, fun, and close proximity to dining, shopping and entertainment. "Grapevine Retreat" is an eight-bedroom, five bath vacation home offers almost 4400 sq feet of living space, and is located only 5 minutes from downtown West Jefferson, 30 minutes to Boone and 30 minutes to Wilkesboro. Thanks to the amenities and prime location, you, your guests, and even your pets will enjoy a vacation you won't soon forget. The spacious living area on the upper level of this home offers an inviting space that's ideal for spending time with family and friends. Enjoy snuggling on a cool Carolina Mountain evening by the gas log fireplace, watch a movie on the large flat-screen TV, admire the beautiful mountain views from the large windows, or play a competitive board game (games provided). While there is plenty of dining options nearby, you won't have to go far to enjoy a scrumptious meal. Just head to the full kitchen equipped with everything you need to prepare a meal to share at one of the four dining tables. Alternatively, a charcoal grill is provided if you'd like to have a cookout. Once you are ready to unwind and get some rest, you can look forward to claiming one of eight private bedrooms. The main floor is home to three bedrooms each with king beds and a flat screen smart TV, and one features an ensuite bathroom. There is also an additional bedroom with two x-long twin beds. On the entrance/ground floor, you will four more bedrooms. Three offer a comfy king size bed and the other features two x-long twins. In addition, the spacious den/game room offers a kitchenette, flat screen smart TV, a gas log fireplace, and a ping-pong table. What a great place for the teenagers to hang out or family just to sit around and talk. WiFi is provided for those need to stay in touch with work or just check emails. This comfy vacation rental is just a short drive from West Jefferson, where you can visit Ashe County Cheese, stroll through downtown enjoying the gorgeous murals while shopping in the unique shops or enjoy dining out at one of the many delicious restaurants. Don't forget about Mount Jefferson State Park and New River State Park or rent a canoe or tube and take a leisurely float down the New River. If you are looking for more fun activities, just head to Boone and Blowing Rock where you can visit Tweetsie

8 Bedrooms
5.5 Bathroom

0 Double Beds
4 Twin Beds

Display Rate

Railroad, Mystery Hill, High Gravity Adventures, Linville Caverns, or spend the day shopping at the famous Tanger Outlets. With so many options you will be sure to make plenty of fun memories to take back home. After a day exploring in the Carolina Mountains, you'll love going back to your spacious vacation rental where there's plenty of room for each family member to have their own space. You're certain to enjoy relaxing on the large deck complete with rocking chairs while taking in the mountain views and cool mountain breezes. GrapeVine Retreat is a Carolina Mountain Vacation Rentals property. Our calendar and rates are updated instantaneously. We strive to make it as easy as possible to stay at one of our properties. We will notify you proactively when an early check in is possible and you'll receive the comforts of a luxury home when you arrive with a starter supply of paper products, hand soaps and lotions. In addition, we offer 24/7 emergency after hours service. Carolina Mountain Properties & Rentals uses one of the industry's most trusted brand of software to securely store all guest data. All of our vacation rentals follow local and state tax rules. Each reservation includes applicable taxes, linen cleaning fee, and a processing fee. Carolina Mountain Properties & Rentals also offers an optional trip interruption insurance to protect your investment. NCREC Broker Name: Carolina Mountain Vacation Rentals, Inc. NCREC License Number: 37802



Amenities Include: combination tub/shower, king, shower, toilet, tub, twin/ single, autumn foliage, churches, cinemas, festivals, forests, library, live theater, museums, restaurants, theme parks, waterfalls, winery tours, Dining, Games, Ping Pong Table, Television, Smart TV, Air Conditioning, Clothes Dryer, Fireplace, Hair Dryer, Heating, Internet, Iron & Board, Linens Provided, Living Room, Parking, Telephone, Towels Provided, Washing Machine, Fire pit, Wifi, Free Wifi, Wifi Speed 25+ Mbps, Coffee Maker, Dishes & Utensils, Dishwasher, Kitchen, Microwave, Oven, Refrigerator, Stove, Toaster, Dining Table, antiquing, bird watching, horseback riding, outlet shopping, photography, scenic drives, sight seeing, walking, ATM/bank, Babysitter, fitness center, groceries, hospital, laundromat, massage therapist, medical services, Mountain, Mountain View, Town, Balcony, Deck / Patio, Lawn / Garden, Outdoor Grill, basketball court, cycling, fishing, fly fishing, freshwater fishing, golf, hiking, ice skating, mountain biking, rafting, skiing, tennis, water tubing, whitewater rafting, children welcome, pets considered, Minimum Age Limit for Renters, Private entrance, flexible, necessary, Guests provide their own meals, Dining Room, Housekeeper Included, Family, Outdoor lighting, Smoke detectors, Carbon monoxide detector, Emergency phone number: Medical, Emergency phone number: Police, Emergency phone number: Fire, Enhanced cleaning practices, Clean with disinfectant, No-contact check-in and check-out, High touch surfaces cleaned with disinfectant, Towels and bedding washed in water that's at least 60sC/140sF, Full Kitchen, Refrigerator, Coffee Maker, Microwave, Toaster, Cookware, Dishwasher, Central Air, Air Conditioning, Ceiling Fans, Linens, Washer & Dryer, WIFI - High Speed Internet, Fireplace, Fireplace - Gas, Nearby ATM, Nearby Post Office, Nearby Internet Cafe, Nearby FedEx, Nearby Bank, Area FitnessCenter, Nearby Medical Services, Nearby Grocery, Outlet Shopping, Movie Theatres, Golf Course, Deck, BBQ Grill, Charcoal Grill, Fire Pit, Biking, Fishing, Hiking, Corn Hole, Close to Town, Blue Ridge Parkway, New River, Grayson Highlands State Park, VA, W. Kerr Scott Lake Nearby, Grandfather Mountain, Stone Mountain State Park, Elk Knob State Park, Mount Jefferson State Park, New River State Park, Internet TV, Pets Up to 25LB, Pets Up To 40LB, Pets - All Sizes, King Size Bed

